

Schueco AWS 70 SC window operation and maintenance guide



Operation

Schueco AWS 70 SC windows are fitted with side hung and/or top hung opening vents fitted with friction hinges. The hinges also act as stays so the vent remains in position when opened. They are designed so that when at their maximum opening angle it is possible to clean the outer pane of glass from inside the room. In some cases, depending on vent size, this may not be possible.

Opening side hung vent

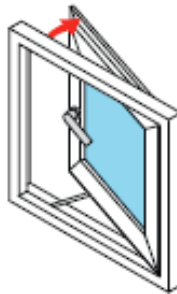
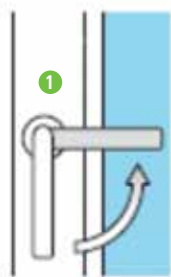

Open ①

1. Turn handle upwards to horizontal position.
2. Push vent outwards.

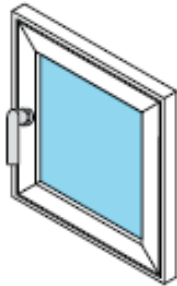

Close

1. Pull vent fully shut.
2. Turn handle downwards to vertical position.
3. Lock handle with key

Opening top hung vent

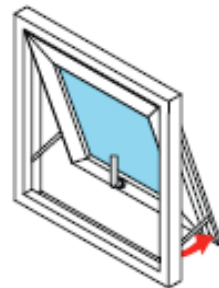
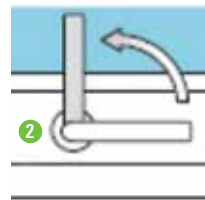

Open ②

1. Turn handle upwards to vertical position.
2. Push vent outwards.

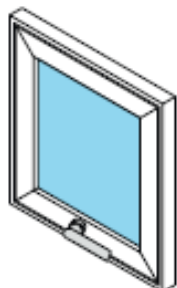

Close

1. Pull vent fully shut.
2. Turn handle downwards to horizontal position.
3. Lock handle with key.

Egress easi-clean hinges (if fitted)

Egress hinges allow the side hung vents to open up to 89° to provide a wider free opening so the window could be used as an exit in the event of a fire.

The easi-clean version allows the vent to be moved into a position so that cleaning of the outer pane of glass can be carried out from inside the room.

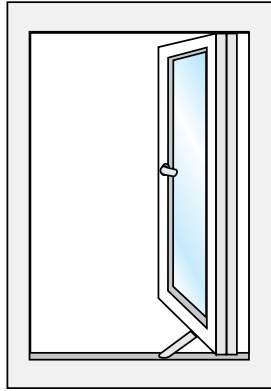

1. Normal operation, window opened to maximum

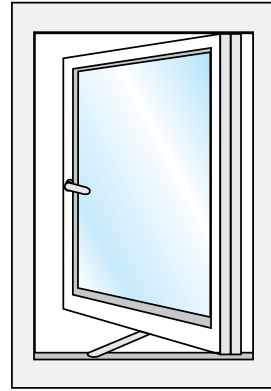

2. Partially close window

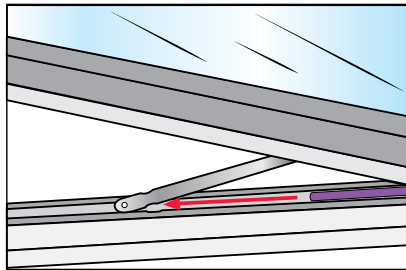

3. Move easi-clean slider on top and bottom hinge to cleaning position

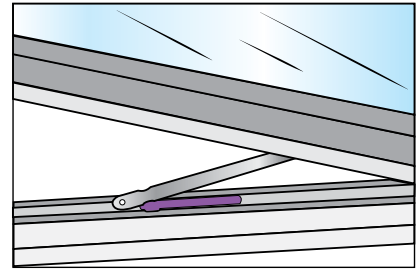

4. Easi-clean slider in cleaning position

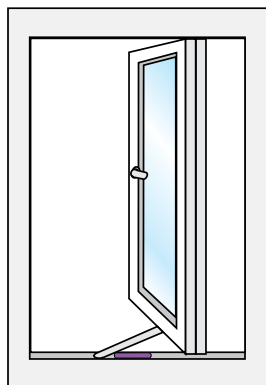

5. Push vent open enough to enable cleaning of outside of glass

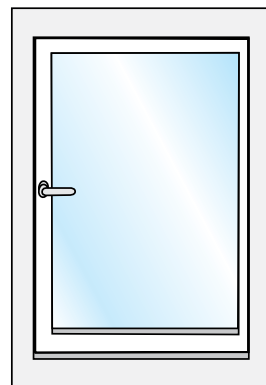

6. Shut vent and then open to maximum. This resets hinges for normal operation

Espagnolette locking

The espagnolette locks are designed to compress the weather seals and for security. The lock keeps have two positions - closed ❶ and night-vent ❷, which allows a small amount of ventilation.

Note that maximum security is only achieved when the lock mushrooms are engaged in the closed position with the handle locked.



Espagnolette lock



Lock keep

Maintenance

Schueco AWS 70 SC aluminium windows require minimum maintenance but cleaning the frames and fittings, together with light lubrication of the moving parts, will keep them looking good and in excellent working order.

The frequency of maintenance will depend on the location of the installation and the relative

air pollution, but as a rule of thumb cleaning and lubrication once a year will be sufficient. In coastal areas or where there is heavy atmospheric pollution, the frequency should be increased. Salt deposits should not be allowed to accumulate on moving mechanical parts.

Cleaning aluminium frames

For the best care, clean the frames and gaskets each time the glass is cleaned. Use a mild, non-scouring cleaning agent making sure that any adhered grit is carefully removed first. Observe the instructions given on the cleaning agent. Mortar or plaster can be removed with a wooden or plastic spatula.

The following must not be used:

Tools with sharp edges, e.g. knives, metal scrapers, steel wool, the scouring side of household sponges etc, will damage surfaces. Aggressive cleaning fluids or solvents e.g. cellulose thinners, nail polish remover etc will cause irreversible damage to the window frame surfaces.



Friction hinges

Wipe down the hinge and slider channel and remove any dirt or debris. Lubricate the hinge pivot points ❶ with a small amount of 3-in-1 oil or spray. Do not use WD40.

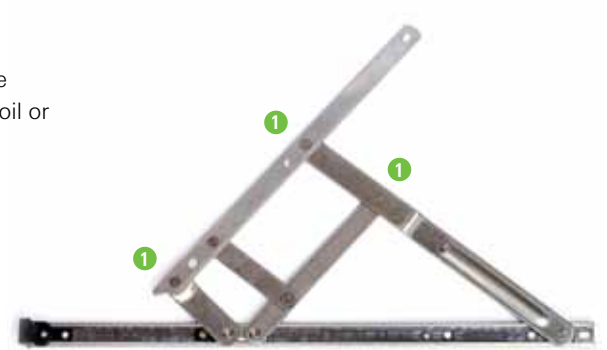

Friction adjustment

Over time it may be necessary to adjust the amount of friction on the hinges. This can be increased or decreased by turning the small brass screw ❷ on the hinge slider (clockwise for more friction, anti-clockwise for less). Both hinges should have equal friction.

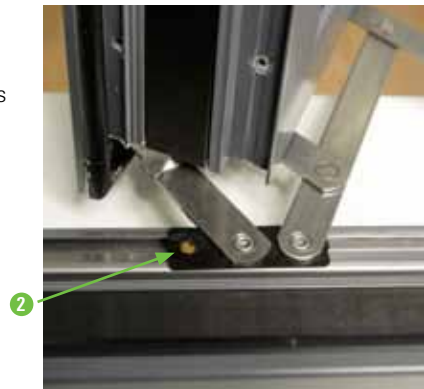

Espagnolette locks

Wipe down the espagnolette lock and apply a small amount of light grease or petroleum jelly to the mushrooms ❸ and into the slots in which the mushrooms slide ❹.



Schueco UK Ltd
www.schueco.co.uk

Schueco – System solutions for windows, doors and façades.

Together with its worldwide network of partners, architects, specifiers and investors, Schueco creates sustainable building envelopes which focus on people and their needs in harmony with nature and technology. The highest demands for design, comfort and security can be met, whilst simultaneously reducing CO₂ emissions through energy efficiency, thereby conserving natural resources. The company and its Metal and PVC-U divisions deliver tailored products for new-builds and renovations, designed to meet individual user needs in all climate zones.

With 4,800 employees and 12,000 partner companies, Schueco is active in 78 countries and achieved a turnover of 1.5 billion euros in 2013. For more information, visit **www.schueco.com**

SCHÜCO
